

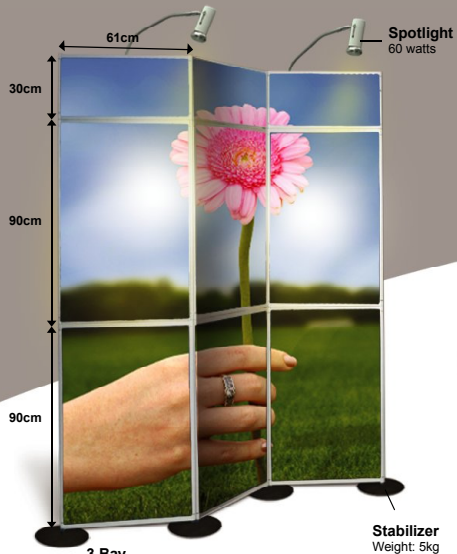

5 Bay

System Size:
305cm (W) x 210cm (H)
(15 panels with detachable header)
Artwork Size:
60.5cm (W) x 27.5cm (H) - Header
60.5cm (W) x 88.5cm (H) - Body
Weight: 22.5kg



3 Bay

System Size:
183cm (W) x 210cm (H)
(9 panels with detachable header)
Artwork Size:
60.5cm (W) x 27.5cm (H) - Header
60.5cm (W) x 88.5cm (H) - Body
Weight: 13.6kg

Stabilizer
Weight: 5kg



4 Bay

System Size:
244cm (W) x 210cm (H)
(12 panels with detachable header)
Artwork Size:
60.5cm (W) x 27.5cm (H) - Header
60.5cm (W) x 88.5cm (H) - Body
Weight: 18kg



CS 001

System Size:
116.8cm (W) x 83.8cm (H) x 45cm (D)
Artwork Size:
71cm (W) x 71cm (H) - Front
28cm (W) x 71cm (H) - Side

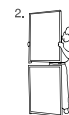



DS 005

System Size:
91.4cm (W) x 99cm (H) x 45.7cm (D)
Artwork Size:
86cm (W) x 67.6cm (H) - Front
40.5cm (W) x 67.6cm (H) - Side



CS 002

System Size:
142cm (W) x 104cm (H) x 66cm (D)
Artwork Size:
68.3cm (W) x 17cm (H) - Header (Front)
36.5cm (W) x 17cm (H) - Header (Side)
71cm (W) x 81cm (H) - Bottom (Front)
28cm (W) x 81cm (H) - Center (Side)



CSH 003

System Size:
76.2cm (W) x 213.4cm (H) x 50.8cm (D)
Artwork Size:
77cm (W) x 80.5cm (H) - Front
52cm (W) x 80.5cm (H) - Side
77cm (W) x 27cm (H) - Header



DS 002

System Size:
116.8cm (W) x 213cm (H) x 45.7cm (D)
Artwork Size:
71cm (W) x 27cm (H) - Header (Front & Back)
28cm (W) x 27cm (H) - Header (Side)
71cm (W) x 88cm (H) - Body (Front)
28cm (W) x 88cm (H) - Body (Side)



DS 003

System Size:
45.7cm (W) x 213cm (H) x 45.7cm (D)
Artwork Size:
50.6cm (W) x 19.7cm (H) - Header
43.2cm (W) x 61.5cm (H) - Body

MAX[®]FOLD

Strong & Impact

MaxFold panel stands provides effortless fitting, easy portability and effective visual impact. Recyclable and reusable to suit your diverse branding needs. Choose from either single or double sided panels; extremely lightweight with mind blowing graphics to captivate audiences. Application suitable for the retail environment, tradeshows and exhibitions.